



Rivnut
Fastening Systems

Rivnut Catalogue

www.rivnut.com.au

CONTENTS

	Page
Steel Rivnuts	1-12
Aluminium Rivnuts	13-15
Stainless Steel Rivnuts	16-24
Jack Nuts	25-26
Rubber Nuts	27-28
Plus Nuts	29-30
Rivstuds	31-32

SHOP ONLINE

WWW.RIVNUT.COM.AU
SALES@RIVNUT.COM.AU

1300 887341

UNIT 3, 57 BOYLAND AVENUE,
COOPERS PLAINS, QLD 4108

Steel Rivnuts



Rivnut
Fastening Systems

1300 887 341
sales@rivnut.com.au
Unit 3, 57 Boyland Avenue,
Coopers Plains, Qld 4108

Rivnut Large Flange Steel - Euro

Material Low Carbon Steel
Finish Zinc Plated



Optimal for high push-out applications. Straight metric hole sizes. Splined body improves torque-to-turn resistance

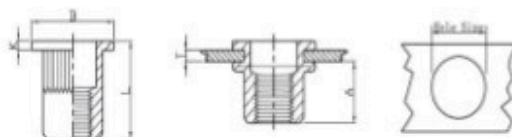

Part Number	Thread	Grip Range	Hole Size	A	B	L	K
RNLFSSE03	M3	0.5-2.0	5	6.00	8.00	10.00	0.80
RNLFSSE04	M4	0.5-2.5	6	6.00	9.00	10.50	0.80
RNLFSSE04-L	M4	2.5-4.0	6	6.00	9.00	12.00	0.80
RNLFSSE05	M5	0.7-3.0	7	7.50	10.00	13.00	1.00
RNLFSSE05-L	M5	2.5-4.0	7	8.50	10.00	16.50	1.00
RNLFSSE06	M6	0.5-3.0	9	9.20	12.30	15.50	1.30
RNLFSSE06-L	M6	3.0-5.0	9	10.50	12.30	19.50	1.30
RNLFSSE08	M8	1.0-3.0	11	11.50	14.50	18.50	1.50
RNLFSSE08-L	M8	3.0-5.5	11	11.50	14.50	21.00	1.50
RNLFSSE10	M10	1.0-4.0	13	13.50	17.00	21.50	1.70
RNLFSSE10-L	M10	4.5-6.0	13	13.50	17.00	24.00	1.70
RNLFSSE12	M12	1.0-4.0	16	13.50	18.00	22.00	2.00
RNLFSSE12-L	M12	4.0-7.0	16	16.00	18.00	28.00	2.00

Thread Size	Pull-Out KN	Push-Out KN	Maximum Torque NM
M3	3.00	1.80	1.50
M4	3.60	2.90	5.10
M5	7.80	4.20	7.90
M6	10.80	6.50	12.40
M8	12.50	7.90	32.00
M10	17.30	10.70	45.00

Dimensions and specifications are subject to change without notice.

www.rivnut.com.au



Rivnut
Fastening Systems

1300 887 341
sales@rivnut.com.au
Unit 3, 57 Boyland Avenue,
Coopers Plains, Qld 4108

Rivnut Small Flange Steel - Euro

Material Low Carbon Steel
Finish Zinc Plated



Optimal for high push-out applications. Straight metric hole sizes. Splined body improves torque-to-turn resistance

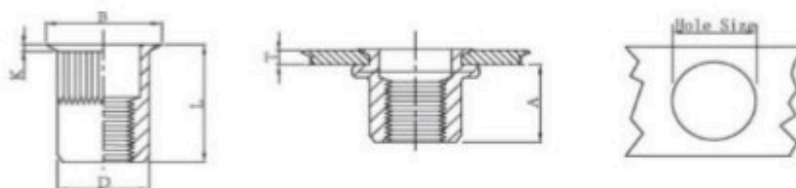

Part Number	Thread	Grip Range	Hole Size	D	B	L	K
RNFFSSE03	M3	0.5-1.5	5	5.00	5.70	9.00	0.50
RNFFSSE04	M4	0.5-2.5	6	6.00	6.50	11.00	0.50
RNFFSSE04-L	M4	2.5-4.0	6	6.00	6.50	12.00	0.50
RNFFSSE05	M5	0.5-2.5	7	7.00	7.60	12.00	0.50
RNFFSSE05-L	M5	2.5-4.0	7	7.00	7.60	14.00	0.50
RNFFSSE06	M6	0.5-3.0	9	9.00	10.00	15.00	0.60
RNFFSSE06-L	M6	3.0-5.0	9	9.00	10.00	17.00	0.60
RNFFSSE08	M8	0.5-3.0	11	11.00	12.00	17.30	0.65
RNFFSSE08-L	M8	3.0-5.0	11	11.00	12.00	18.50	0.65
RNFFSSE10	M10	1.0-4.0	13	13.00	14.00	20.50	0.65
RNFFSSE10-L	M10	4.0-6.0	13	13.00	14.00	23.50	0.65
RNFFSSE12	M12	1.0-4.0	16	16.00	17.00	24.00	0.65

www.rivnut.com.au



Rivnut
Fastening Systems

1300 887 341
sales@rivnut.com.au
Unit 3, 57 Boyland Avenue,
Coopers Plains, Qld 4108

Rivnut Large Flange Steel - DL Series

Material Low Carbon Steel

Finish Zinc Plated



Highest resistance to vibration and spin out of all round bodied rivnuts. Flange are wide and near flush finish. Very wide grip range.

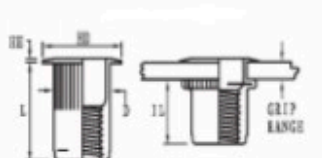

Part Number	Thread	Grip Range	Hole Size	A	L	HD	HH
RNLFSDL04	M4	0.5-2.0	6.75	6.70	11.46	9.90	0.76
RNLFSDL04-L	M4	2.0-3.3	6.75	6.70	12.70	9.90	0.76
RNLFSDL05	M5	0.5-3.3	7.6	7.50	12.85	10.55	0.76
RNLFSDL05-L	M5	3.3-5.7	7.6	7.50	15.50	10.55	0.76
RNLFSDL06	M6	0.7-4.2	10	9.92	15.50	12.70	0.76
RNLFSDL06-L	M6	4.2-6.6	10	9.92	18.00	12.70	0.76
RNLFSDL08	M8	0.7-3.8	13.5	13.45	18.40	17.40	0.76
RNLFSDL08-L	M8	3.8-7.9	13.5	13.45	21.35	17.40	0.76
RNLFSDL10	M10	0.7-3.8	13.5	13.45	18.40	17.45	0.76
RNLFSDL10-L	M10	3.8-7.9	13.5	13.45	21.20	17.45	0.76
RNLFSDL12	M12	1.6-5.1	17.5	17.45	30.40	21.98	0.76
RNLFSDL12-L	M12	5.1-8.9	17.5	17.45	34.21	21.98	0.76
RNLFSDL12-12.7	M12	8.9-12.7	17.5	17.45	38.00	21.98	0.76

Thread Size	Pull-Out KN	Push-Out	
		KN	Maximum Torque NM
M4	6.90	2.00	5.90
M5	7.80	2.90	9.80
M6	11.00	3.90	18.10
M8	20.00	6.90	29.40
M10	20.00	6.90	45.00
M12	19.90		72.00

Dimensions and specifications are subject to change without notice.

www.rivnut.com.au



Rivnut
Fastening Systems

1300 887 341
sales@rivnut.com.au
Unit 3, 57 Boyland Avenue,
Coopers Plains, Qld 4108

Rivnut Small Flange Steel - DK Series

Material Low Carbon Steel

Finish Zinc Plated



Highest resistance to vibration and spin out of all round bodied rivnuts. Small Flange flush finish with a wide grip range.



Part Number	Thread	Grip		A	L	HD	HH
		Range	Hole Size				
RNFFSDK04	M4	0.5-2.0	6.75	6.70	11.46	7.84	0.55
RNFFSDK04-L	M4	2.0-3.3	6.75	6.70	12.70	7.84	0.55
RNFFSDK05	M5	0.5-3.3	7.6	7.50	12.85	8.65	0.55
RNFFSDK05-L	M5	3.3-5.7	7.6	7.50	15.50	8.65	0.55
RNFFSDK06	M6	0.7-4.2	10	9.92	15.50	11.60	0.55
RNFFSDK06-L	M6	4.2-6.6	10	9.92	18.00	11.60	0.55
RNFFSDK08	M8	0.7-3.8	13.5	13.45	18.40	15.10	0.55
RNFFSDK08-L	M8	3.8-7.9	13.5	13.45	21.35	15.10	0.55
RNFFSDK10	M10	0.7-3.8	13.5	13.45	18.40	15.10	0.55
RNFFSDK10-L	M10	3.8-7.9	13.5	13.45	21.20	15.10	0.55

Thread Size	Push-Out		
	Pull-Out KN	KN	Maximum Torque NM
M4	6.86	1.47	5.88
M5	7.84	1.67	10.78
M6	10.80	2.65	20.59
M8	19.60	3.64	36.28
M10	19.60	3.64	56.88

Dimensions and specifications are subject to change without notice.

www.rivnut.com.au



Rivnut
Fastening Systems

1300 887 341
sales@rivnut.com.au
Unit 3, 57 Boyland Avenue,
Coopers Plains, Qld 4108

Rivnut Large Flange Steel - Hex Body

Material Low Carbon Steel
Finish Zinc Plated



Highest resistance to vibration and spin out of all round bodied rivnuts. Flange are wide and near flush finish. Very wide grip range.

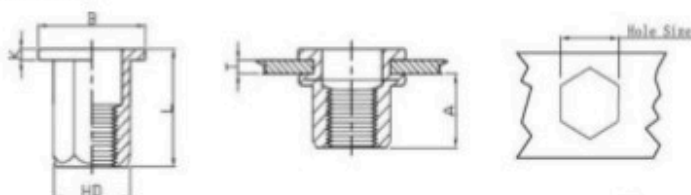

Part Number	Thread	Grip Range	Hole Size	HD	L	B	K
RNLFSHB04HH	M4	0.5-2.0	6	6.00	10.75	9.00	0.80
RNLFSHB05	M5	0.5-3.0	7	7.00	13.80	10.00	1.00
RNLFSHB06HH	M6	0.6-3.0	9	9.00	16.00	13.00	1.50
RNLFSHB08	M8	0.7-3.0	11	11.00	18.00	16.00	1.50
RNLFSHB08-L	M8	3.0-5.5	11	11.00	20.50	16.00	1.50
RNLFSHB10	M10	1.0-4.0	13	13.00	24.00	19.00	2.00
RNLFSHB10-L	M10	4.0-6.0	13	13.00	26.00	19.00	2.00
RNLFSHB12	M12	1.0-4.0	16	16.00	27.00	23.00	2.00

Thread Size	Pull-Out		Maximum Torque NM
	KN	KN	
M4	6.30	2.00	4.90
M5	8.80	3.60	7.80
M6	14.40	5.30	12.00
M8	15.00	8.00	32.00
M10	19.70	9.00	45.00
M12	21.30	10.20	60.00

Dimensions and specifications are subject to change without notice.

www.rivnut.com.au



Rivnut
Fastening Systems

1300 887 341
sales@rivnut.com.au
Unit 3, 57 Boyland Avenue,
Coopers Plains, Qld 4108

Rivnut Small Flange Steel - Hex Body

Material Low Carbon Steel

Finish Zinc Plated



Small flange head with hexagon metric hole provides maximum resistance to unscrewing torque.

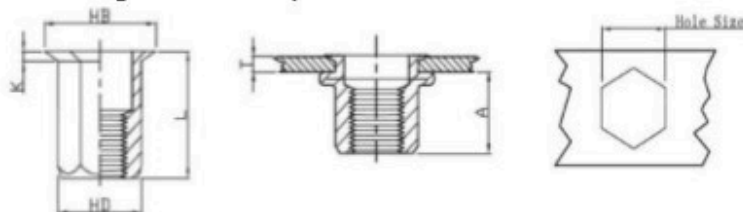

Part Number	Thread	Grip Range	Hole Size	HD	L	HB	K
RNFFSHB04	M4	0.5-2.0	6	6.00	10.00	7.00	0.50
RNFFSHB05	M5	0.5-3.0	7	7.00	12.00	8.00	0.60
RNFFSHB06	M6	0.6-3.0	9	9.00	15.00	10.00	0.60
RNFFSHB08	M8	0.7-3.0	11	11.00	17.50	12.00	0.50
RNFFSHB10	M10	1.0-4.5	13	13.00	23.00	14.50	1.00

Thread Size	Pull-Out		Maximum Torque NM
	KN	KN	
M4	6.30	1.40	5.10
M5	8.00	2.50	7.80
M6	14.00	3.00	12.30
M8	15.00	4.00	31.40
M10	19.70	5.20	45.00

Dimensions and specifications are subject to change without notice.

www.rivnut.com.au



1300 887 341
 sales@rivnut.com.au
 Unit 3, 57 Boyland Avenue,
 Coopers Plains, Qld 4108

Rivnut Wide Flange Semi-Hex Body AL Series



Material Low Carbon Steel
Finish Zinc Plated

Highest resistance to vibration and spin out of all round bodied rivnuts. Flange are wide and near flush finish. Very wide grip range.

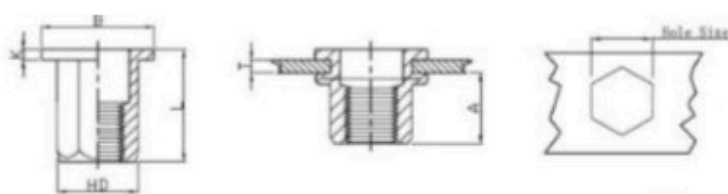

Part Number	Thread	Grip Range	B	L	K	HB	Pull Out KN	Push Out KN	Torque NM
RN-AL-SHB-06-4.2	M6	0.7-4.2	12.95	14.9	0.75	9.5	11.77	3.43	13.73
RN-AL-SHB-06-6.6	M6	4.2-6.6		18.0					
RN-AL-SHB-08-3.8	M8	0.7-3.8	16.65	17.4	0.9	12.7	15.69	5.39	35.3
RN-AL-SHB-08-7.9	M8	3.8-7.9		21.5					
RN-AL-SHB-10-3.8	M10	0.7-3.8		17.4					
RN-AL-SHB-10-7.9	M10	3.8-7.9		21.5			12.75	4.9	46.1

*Due to the variability of grip, material type and installation technique, the data provided is offered as a guide only. For exact engineering data we recommend specific testing of your application.



Rivnut
Fastening Systems

1300 887 341
sales@rivnut.com.au
Unit 3, 57 Boyland Avenue,
Coopers Plains, Qld 4108

Steel Hexagon Low Profile Rivnuts

Material: Low Carbon Steel

Finish: Zinc Clear Cr3

Low profile head, used in conjunction with an imperial hexagon hole to give maximum



Part Number	Thread	Grip Range	Hole Size	A	B	C	D	Pull Out KN	Push Out KN	Torque NM
IN88-0530	M5	0.5-3.0	7.2	7.1	12.0	8.1	0.5	5.9	1.9	7.9
IN88-0633	M6	0.7-3.3	9.6	9.5	14.5	10.5	0.5	6.9	2.4	12.4
IN88-0833	M8	0.7-3.3	10.6	10.5	16.0	11.5	0.5	14.8	2.8	16.4

Dimensions and specifications are subject to change without notice. Check your distributor for the latest data sheet. The test data provides approximate strength values averaged in multiple tests in various materials and thicknesses. We recommend testing your application when an exact strength figure is required, or the load to be applied comes close to the published data.

www.rivnut.com.au



Rivnut
Fastening Systems

1300 887 341
sales@rivnut.com.au
Unit 3, 57 Boyland Avenue,
Coopers Plains, Qld 4108

Rivnut Small Flange Steel - Smooth Body

Material Low Carbon Steel

Finish Zinc Plated



Highest resistance to vibration and spin out of all round bodied rivnuts. Flange are wide and near flush finish. Very wide grip rang

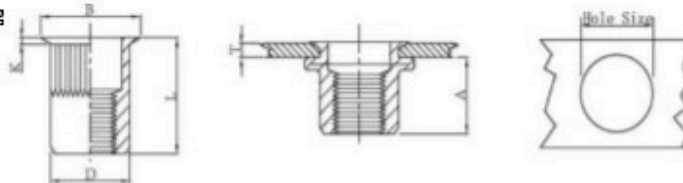

Part Number	Thread	Grip Range	Hole Size	D	L	B	K
RN58-0315	M3	0.5-1.5	4.8	4.80	9.00	5.30	0.40
RN58-0413	M4	0.5-2.0	6.4	6.40	10.40	7.10	0.45
RN58-0514	M5	0.5-3.0	7.2	7.20	12.00	8.10	0.50
RN58-0619	M6	0.8-3.0	9.6	9.60	15.00	10.50	0.60
RN58-2022	M8	0.9-3.0	10.6	10.60	16.00	11.50	0.60

Thread Size	Pull-Out KN	Push-Out	Maximum Torque NM
M4	2.70	0.80	1.60
M5	6.10	1.50	5.20
M6	8.00	1.90	7.80
M8	11.40	2.50	12.70

Dimensions and specifications are subject to change without notice.

www.rivnut.com.au



Rivnut
Fastening Systems

1300 887 341
sales@rivnut.com.au
Unit 3, 57 Boyland Avenue,
Coopers Plains, Qld 4108

Rivnut Large Flange Steel - Closed End

Material Low Carbon Steel

Finish Zinc Plated



Highest resistance to vibration and spin out of all round bodied rivnuts. Flange are wide and near flush finish. Very wide grip range.

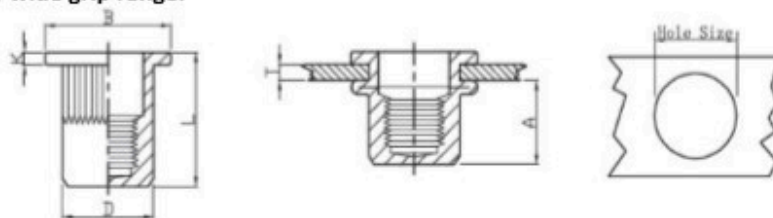

Part Number	Thread	Grip Range	Hole Size	D	L	B	K
RNLFSSE04CE	M4	0.5-2.5	6	6.00	15.60	9.00	0.80
RNLFSSE05CE	M5	0.5-2.5	7	7.00	17.90	10.00	1.00
RNLFSSE06CE	M6	0.5-3.0	9	9.00	21.40	13.00	1.50
RNLFSSE08CE	M8	1.0-3.0	11	11.00	24.45	16.00	1.50
RNLFSSE10CE	M10	1.0-3.5	13	12.95	29.00	16.00	1.70

Thread Size	Pull-Out KN	Push-Out KN	Maximum Torque NM
M4	5.70	2.10	4.90
M5	10.70	3.00	7.80
M6	11.10	5.30	12.70
M8	18.10	6.90	16.70
M10	28.60	8.70	40.00

Dimensions and specifications are subject to change without notice.

www.rivnut.com.au



Rivnut
Fastening Systems

1300 887 341
sales@rivnut.com.au
Unit 3, 57 Boyland Avenue,
Coopers Plains, Qld 4108

Rivnut Small Flange Steel - Closed End

Material Low Carbon Steel

Finish Zinc Plated



Highest resistance to vibration and spin out of all round bodied rivnuts. Flange are wide and near flush finish. Very wide grip range.

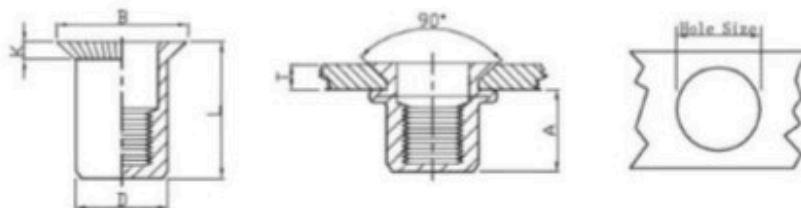

Part Number	Thread	Grip Range	Hole Size	D	L	B	K
RNFFSSE04CE	M4	0.5-2.5	6	6.00	15.00	6.80	0.50
RNFFSSE05CE	M5	0.5-2.5	7	7.00	18.00	7.90	0.50
RNFFSSE06CE	M6	0.5-3.0	9	9.00	21.50	10.00	0.50
RNFFSSE08CE	M8	1.0-3.0	11	11.00	22.50	12.00	0.50

Thread Size	Pull-Out		Maximum Torque NM
	KN	KN	
M4	1.50	1.50	5.10
M5	2.00	2.00	7.80
M6	2.50	2.50	12.40
M8	2.90	2.90	16.40

Dimensions and specifications are subject to change without notice.

www.rivnut.com.au

Aluminium Rivnuts



Rivnut
Fastening Systems

1300 887 341
sales@rivnut.com.au
Unit 3, 57 Boyland Avenue,
Coopers Plains, Qld 4108

Rivnut Large Flange Aluminium

Material Aluminium
Finish Chemically Brightened



Optimal for high push-out applications. Straight metric hole sizes. Splined body improves torque-to-turn resistance

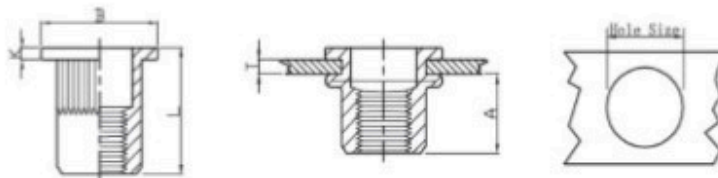

Part Number	Thread	Grip Range	Hole Size	A	B	L	K
RNLFA0315	M3	0.5-1.5	5	5.00	8.00	9.80	0.80
RNLFA0420	M4	0.8-2.5	6	6.00	9.00	11.30	0.80
RNLFA0525	M5	0.8-2.5	7	7.50	10.00	12.50	1.00
RNLFA0625	M6	1.0-2.5	9	9.20	12.50	15.10	1.50
RNLFA0640	M6	2.5-4.0	9	9.20	12.50	16.50	1.50
RNLFA0825	M8	1.0-2.5	11	10.20	14.50	16.50	1.50
RNLFA0840	M8	2.5-4.0	11	10.20	14.50	18.00	1.50
RNLFA1025	M10	1.0-4.0	13	11.50	16.50	18.00	1.50

Thread Size	Pull-Out		Maximum Torque NM
	KN	KN	
M3	3.00	0.90	1.20
M4	4.00	1.00	3.60
M5	5.00	1.50	5.30
M6	8.00	2.00	10.80
M8	11.00	2.50	23.00
M10	13.00	4.00	28.00

Dimensions and specifications are subject to change without notice.

www.rivnut.com.au



Rivnut
Fastening Systems

1300 887 341
sales@rivnut.com.au
Unit 3, 57 Boyland Avenue,
Coopers Plains, Qld 4108

Rivnut Small Flange Aluminium

Material Aluminium
Finish Chemically Brightened



Optimal for high push-out applications. Straight metric hole sizes. Splined body improves torque-to-turn resistance

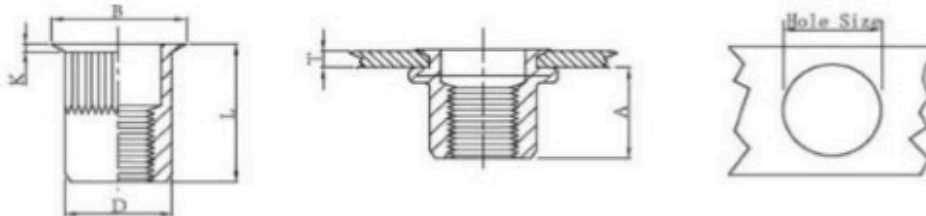

Part Number	Thread	Grip		A	B	L	K
		Range	Hole Size				
RNFFA0315	M3	0.5-1.5	5	5.00	8	9.00	0.50
RNFFA0420	M4	0.8-2.5	6	6.00	9	10.50	0.50
RNFFA0525	M5	0.8-2.5	7.5	7.50	10	11.50	0.50
RNFFA0625	M6	1.0-2.5	9.2	9.20	12.5	14.00	0.60
RNFFA0640	M6	2.5-4.0	9.2	9.20	12.5	14.00	0.65
RNFFA0825	M8	1.0-2.5	10.2	10.20	14.5	15.50	0.65
RNFFA0840	M8	2.5-4.0	10.8	10.20	14.5	15.50	0.65
RNFFA10	M10	1.0-4.0	11.5	11.50	16.5	17.70	0.70

Thread Size	Pull-Out		Maximum Torque NM
	KN	KN	
M3	3.00	0.60	1.20
M4	3.70	0.07	3.60
M5	5.40	0.80	5.30
M6	8.50	0.90	10.80
M8	12.30	1.00	23.00
M10	15.60	1.10	28.00

Dimensions and specifications are subject to change without notice.

www.rivnut.com.au

Stainless Steel Rivnuts



Rivnut
Fastening Systems

1300 887 341
sales@rivnut.com.au
Unit 3, 57 Boyland Avenue,
Coopers Plains, Qld 4108

Rivnut Large Flange Stainless Steel-Euro

Material Stainless Steel A2
Finish Stainless Steel A2



Optimal for high push-out applications. Straight metric hole sizes. Splined body improves torque-to-turn resistance

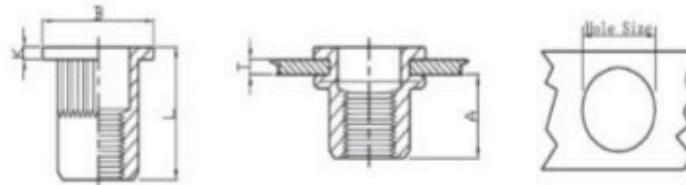

Part Number	Thread	Grip	Hole Size	A	B	L	K
RNLFST03	M3	0.5-2.0	5	6.00	8.00	10.00	0.80
RNLFST04	M4	0.5-2.5	6	6.00	9.00	10.50	0.80
RNLFST04-L	M4	2.5-4.0	6	6.00	9.00	12.00	0.80
RNLFST05	M5	0.7-3.0	7	7.50	10.00	13.00	1.00
RNLFST05-L	M5	2.5-4.0	7	8.50	10.00	16.50	1.00
RNLFST06	M6	0.5-3.0	9	9.20	12.30	15.50	1.30
RNLFST06-L	M6	2.5-5.0	9	10.50	12.30	19.50	1.30
RNLFST08	M8	1.0-3.0	11	11.50	14.50	18.50	1.50
RNLFST08-L	M8	3.0-5.5	11	11.50	14.50	21.00	1.50
RNLFST10	M10	1.0-4.0	13	13.50	17.00	21.50	1.70
RNLFST10-L	M10	4.5-6.0	13	13.50	17.00	24.00	1.70
RNLFST12	M12	1.0-4.0	16	13.50	18.00	22.00	2.00

Thread Size	Pull-Out	Push-Out	Maximum Torque NM
M3	5.30	3.30	3.00
M4	9.80	4.90	4.90
M5	15.70	6.90	9.80
M6	20.60	9.80	15.50
M8	29.40	12.70	29.50
M10	42.20	15.70	35.00

Dimensions and specifications are subject to change without notice.

www.rivnut.com.au



Rivnut
Fastening Systems

1300 887 341
sales@rivnut.com.au
Unit 3, 57 Boyland Avenue,
Coopers Plains, Qld 4108

Rivnut Small Flange Stainless Steel

Material Stainless Steel A2
Finish Stainless Steel A2



Optimal for high push-out applications. Straight metric hole sizes. Splined body improves torque-to-turn resistance

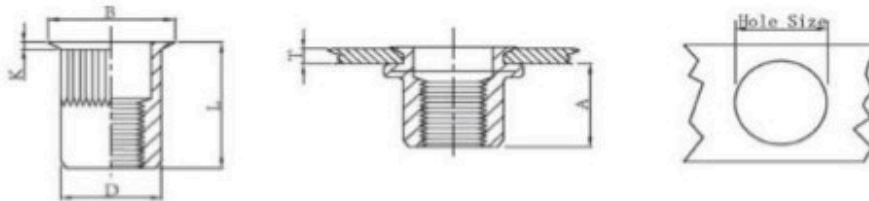

Part Number	Thread	Grip	Hole Size	A	B	L	K
RNFFST03		0.5-1.5	5	5.00	8	9.00	0.50
RNFFST04		0.5-2.5	6	6.00	9	10.50	0.50
RNFFST05		0.5-2.5	7	7.50	10	11.50	0.50
RNFFST06		0.5-3.0	9	9.20	12.5	14.00	0.60
RNFFST08		0.5-3.0	11	9.20	12.5	14.00	0.65
RNFFST10		1.0-4.0	13	10.20	14.5	15.50	0.65
RNFFST12		1.0-4.0	16	10.20	14.5	15.50	0.65

Thread Size	Pull-Out	Push-Out	Maximum Torque NM
M3	4.90	2.00	3.00
M4	9.80	2.90	4.90
M5	15.70	2.90	9.80
M6	20.60	3.00	15.50
M8	29.40	4.00	29.50
M10	42.20	6.00	35.00

www.rivnut.com.au



Rivnut
Fastening Systems

1300 887 341
sales@rivnut.com.au
Unit 3, 57 Boyland Avenue,
Coopers Plains, Qld 4108

Rivnut Large Flange Stainless Steel - DL Series

Material Stainless Steel A2

Finish Stainless Steel A2



Highest resistance to vibration and spin out of all round bodied rivnuts. Flange are wide and near flush finish. Very wide grip range.

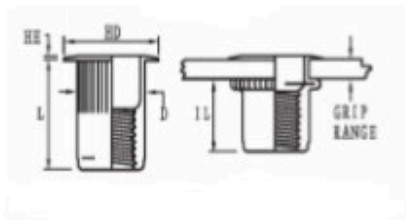

Part Number	Thread	Range	Hole Size	A	L	HD	HH
RNLFSTDLO4	M4	0.5-2.0	6.75	6.70	11.46	9.90	0.76
RNLFSTDLO5	M5	0.5-3.3	7.6	7.50	12.85	10.55	0.76
RNLFSTDLO6	M6	0.7-4.2	10	9.92	15.50	12.70	0.76
RNLFSTDLO6-L	M6	4.2-6.6	10	9.92	18.00	12.70	0.76
RNLFSTDLO8	M8	0.7-3.8	13.5	13.45	18.40	17.40	0.76
RNLFSTDLO8-L	M8	3.8-7.9	13.5	13.45	21.35	17.40	0.76
RNLFSTDLO10	M10	0.7-3.8	13.5	13.45	18.40	17.45	0.76
RNLFSTDLO10-L	M10	3.8-7.9	13.5	13.45	21.20	17.45	0.76

Thread Size	KN	KN	Maximum Torque NM
M4	8.30	4.50	4.90
M5	12.00	5.50	9.80
M6	22.00	7.50	15.50
M8	34.00	11.50	49.00
M10	34.00	11.50	

Dimensions and specifications are subject to change without notice.

www.rivnut.com.au



1300 887 341
 sales@rivnut.com.au
 Unit 3, 57 Boyland Avenue,
 Coopers Plains, Qld 4108

Rivnut Large Flange Stainless Steel - Closed End

Material Stainless Steel A2

Finish Stainless Steel A2



Optimal for high push-out applications. Straight metric hole sizes. Splined body improves torque-to-turn resistance

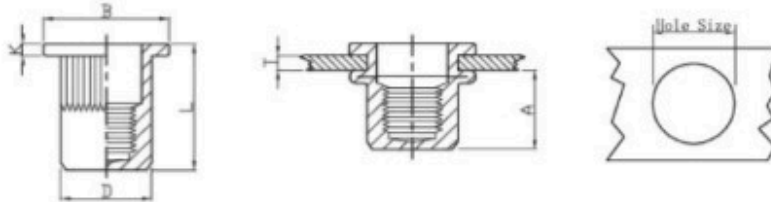

Part Number	Thread	Grip Range	Hole Size	D	L	B	K
RNLFST04CE	M4	0.5-2.5	6	6.00	15.60	9.00	0.80
RNLFST05CE	M5	0.5-2.5	7	7.00	17.90	10.00	1.00
RNLFST06CE	M6	0.5-3.0	9	9.00	21.40	13.00	1.50
RNLFST08CE	M8	1.0-3.0	11	11.00	24.45	16.00	1.50
RNLFST10CE	M10	1.0-3.5	13	12.95	29.00	16.00	1.70

Thread Size	Pull-Out		Maximum Torque NM
	KN	KN	
M4	12.70	5.40	9.80
M5	20.60	8.80	14.70
M6	32.40	10.80	44.10

Dimensions and specifications are subject to change without notice.

www.rivnut.com.au



Rivnut
Fastening Systems

1300 887 341
sales@rivnut.com.au
Unit 3, 57 Boyland Avenue,
Coopers Plains, Qld 4108

Rivnut Small Flange Stainless Steel - Closed End

Material Stainless Steel A2

Finish Stainless Steel A2

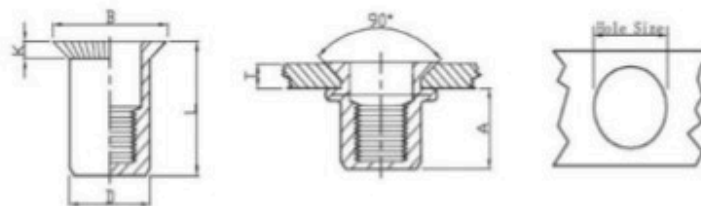

Part Number	Thread	Grip		D	L	B	K
		Range	Hole Size				
RNFFST04CE	M4	0.5-2.5	6	6.00	15.00	6.80	5.38
RNFFST05CE	M5	0.5-2.5	7	7.00	18.00	7.90	6.39
RNFFST06CE	M6	0.5-3.0	9	9.00	21.50	10.00	12.68
RNFFST08CE	M8	1.0-3.0	11	11.00	22.50	12.00	13.68
RNFFST10CE	M10	1.0-3.5	13	12.90	26.50	14.20	0.80

Thread Size	Pull-Out KN	Push-Out	Maximum Torque NM
M4	9.00	1.00	5.50
M5	12.00	2.70	11.00
M6	18.00	2.90	16.90
M8	24.00	3.20	22.50
M10	44.10	5.40	

www.rivnut.com.au



Rivnut
Fastening Systems

1300 887 341
sales@rivnut.com.au
Unit 3, 57 Boyland Avenue,
Coopers Plains, Qld 4108

Rivnut Large Flange Stainless Steel - Hex Body

Material Stainless Steel A2

Finish Stainless Steel A2



Highest resistance to vibration and spin out of all round bodied rivnuts. Flange are wide and near flush finish. Very wide grip range.

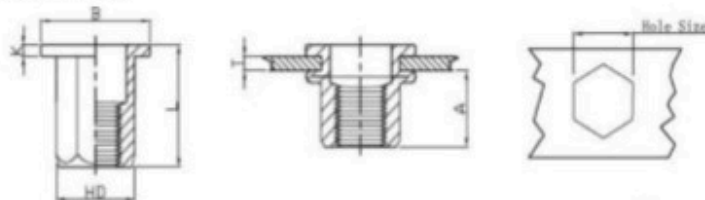

Part Number	Thread	Grip Range	Hole Size	HD	L	B	K
HEX-SLFE-0420	M4	0.5-2.0	6	6.00	10.75	9.00	0.80
HEX-SLFE-0530	M5	0.5-3.0	7	7.00	13.80	10.00	1.00
HEX-SLFE-0630	M6	0.6-3.0	9	9.00	16.00	13.00	1.50
HEX-SLFE-0830	M8	0.7-3.0	11	11.00	18.00	16.00	1.50
HEX-SLFE-1040	M10	1.0-4.5	13	13.00	24.00	19.00	2.00

Thread Size	Pull-Out KN	Push-Out KN	Maximum Torque NM
M4	6.30	2.00	4.90
M5	8.80	3.60	7.80
M6	14.40	5.30	12.00
M8	15.00	8.00	32.00
M10	19.70	9.00	45.00

Dimensions and specifications are subject to change without notice.

www.rivnut.com.au



Rivnut
Fastening Systems

1300 887 341
sales@rivnut.com.au
Unit 3, 57 Boyland Avenue,
Coopers Plains, Qld 4108

Rivnut Small Flange Stainless Steel - Hex Body

Material Stainless Steel A2

Finish Stainless Steel A2



Small flange head with hexagon metric hole provides maximum resistance to unscrewing torque.

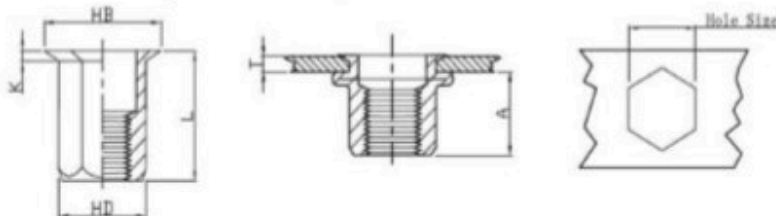

Part Number	Thread	Grip Range	Hole Size	HD	L	HB	K
HEX-SSFE-0420	M4	0.5-2.0	6	6.00	10.00	7.00	0.50
HEX-SSFE-0530	M5	0.5-3.0	7	7.00	12.00	8.00	0.60
HEX-SSFE-0620	M6	0.6-3.0	9	9.00	15.00	10.00	0.60
HEX-SSFE-0830	M8	0.7-3.0	11	11.00	17.50	12.00	0.50
HEX-SSFE-1040	M10	1.0-4.5	13	13.00	23.00	14.50	1.00

Thread Size	Pull-Out		Maximum Torque NM
	KN	KN	
M4	6.30	1.40	5.10
M5	8.00	2.50	7.80
M6	14.00	3.00	12.30
M8	15.00	4.00	31.40
M10	19.70	5.20	45.00

Dimensions and specifications are subject to change without notice.

www.rivnut.com.au



1300 887 341
 sales@rivnut.com.au
 Unit 3, 57 Boyland Avenue,
 Coopers Plains, Qld 4108

Stainless Hexagon Closed End Rivnut

Material: Stainless Steel SS304

Low profile head, used in conjunction with a metric hexagon hole to give maximum resistance to applied torque or unscrewing torque. For applications where sealing to prevent the ingress of solids or moisture is desirable.



Thread Size	Part Number	Grip Range	Hole Size	A	B	C	D	Pull Out	Push Out	Maximum Torque
M4	HEX-SSFE-0425-CE	0.5-2.5	6.1	6.0	16.0	7.0	0.5	7.4	2	4.9
M5	HEX-SSFE-0530-CE	0.5-3.0	7.1	7.0	18.0	8.0	0.5	11.8	2.5	9.8
M6	HEX-SSFE-0630-CE	0.5-3.0	9.1	9.0	21.0	10.0	0.5	22.6	3.4	14.7
M8	HEX-SSFE-0830-CE	0.5-3.0	11.1	11.0	23.5	12.0	0.5	27.5	3.9	44.1
	HEX-SSFE-0855-CE	3.0-5.5	11.1	11.0	26.0	12.0	0.5	27.5	3.9	44.1
M10	HEX-SSFE-1035-CE	1.5-3.5	13.1	13.0	26.5	14.2	0.5	31.4	4.4	

Dimensions and specifications are subject to change without notice. Check your distributor for the latest data sheet. The test data provides approximate strength values averaged in multiple tests in various materials and thicknesses. We recommend testing your application when an exact strength figure is required, or the load to be applied comes close to the published data.

www.rivnut.com.au

Jack Nuts



1300 887 341
 sales@rivnut.com.au
 Unit 3, 57 Boyland Avenue,
 Coopers Plains, Qld 4108

Jack Nut

Material Low Carbon Steel

Finish: Zinc Clear Cr3

Jack Nuts are a unique series of threaded insert designed for use in light duty, thin, or fragile materials. When installed, the body of the Jack Nut collapses to form a large footprint which provide a durable grip on blind side. Jack Nuts can be installed into slightly oversized holes, uneven surfaces and won't distort the material including soft plastics.

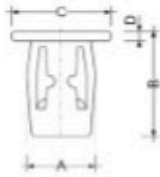

Part Number	Thread	Grip Range		A	B	C	D
RNJK-0401	M4	0.0-5.0		8.50	16.80	12.20	1.60
RNJK-0402	M4	5.0-10.0		8.50	22.00	12.20	1.60
RNJK-0501	M5	0.0-5.0		10.50	18.40	14.00	1.60
RNJK-0502	M5	5.0-10.0		10.50	23.20	14.00	1.60
RNJK-0601	M6	0.0-5.0		12.00	18.60	16.00	1.60
RNJK-0602	M6	5.0-10.0		12.00	22.90	16.00	1.60
RNJK-0801	M8	0.0-5.0		15.50	19.00	18.00	1.80
RNJK-0802	M8	5.0-8.0		15.50	24.00	18.00	1.80
RNJK-0601-14	1/4"	0.0-5.0		11.00	18.60	16.00	1.60

Diagrams and Drawings are for measuring purposes only. Dimensions and specifications are subject to change without notice. The test data provides approximate strength values averaged in multiple tests in various materials and thicknesses.

www.rivnut.com.au

Rubber Nuts



Rivnut
Fastening Systems

1300 887 341
sales@rivnut.com.au
Unit 3, 57 Boyland Avenue,
Coopers Plains, Qld 4108

Rubber Nut series

Material E.P.D.M Rubber Body / Brass



Rubber Nuts are optimal for applications where isolation to reduce vibration and noise

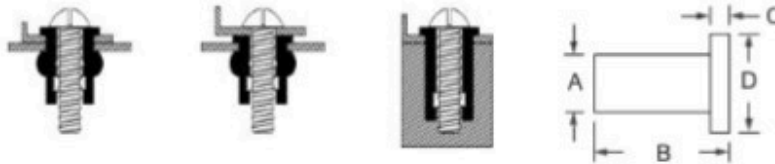

Part Number	Thread	Grip Range	A	B	C	D
RNM3100	M3	0.4-4.0	8.00	12.60	1.40	11.00
RNM3250	M3	9.5-13.0	8.00	24.90	0.90	14.00
RNM4100	M4	0.4-4.0	8.00	126.00	1.40	11.00
RNM4140	M4	0.4-4.4	8.00	14.20	1.50	19.10
RNM4240	M4	8.5-15.0	8.00	24.00	1.20	11.00
RNM5150	M5	0.5-4.9	9.70	14.10	0.90	12.70
RNM5190	M5	0.8-5.8	9.70	20.90	4.70	19.00
RNM5200	M5	8.0-11.5	9.70	21.50	0.90	14.00
RNM5250	M5	7.9-15.0	9.70	26.50	1.30	14.00
RNM6150	M6	0.4-4.0	12.80	16.00	1.30	16.00
RNM6200	M6	4.7-8.7	12.80	21.10	4.75	19.00
RNM6250	M6	6.4-11.5	12.80	26.70	2.00	16.30
RNM6350	M6	11.5-23.0	13.10	35.00	1.30	16.00
RNM8200	M8	0.4-4.0	16.00	18.3	3.2	21.5
RNM8300	M8	2.0-18	18.10	30.00	2.00	20.5
RNM8500	M8	15.0-39.0	18.10	50	1.6	20.00
RNM1055	M10	19.0-40.0	20.10	56.00	1.3	22.5
RNM127	M12	38.0-64.0	24.10	78	1.3	27.00

Diagrams and Drawings are for measuring purposes only. Dimensions and specifications are subject to change without notice.
The test data provides approximate strength values averaged in multiple tests in various materials and thicknesses.

www.rivnut.com.au

Plus Nuts



Rivnut
Fastening Systems

1300 887 341
sales@rivnut.com.au
Unit 3, 57 Boyland Avenue,
Coopers Plains, Qld 4108

Plus Nut

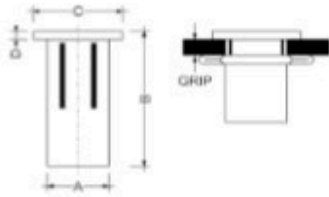

Material Low Carbon Steel

Finish Zinc Plated

Optimal for high push-out applications. Straight metric hole sizes. Splined body improves torque-to-turn resistance

Part Number	Thread	Grip Range	Hole Size	A	B	C	D
RN-PNS-0504	M5	0.5-4.45	7.5	7.47	22	12.7	0.96
RN-PNS-0508	M5	4.45-8.1	7.5	7.47	24.8	12.7	0.96
RN-PNS-0607	M6	0.5-7.1	10	8.79	26.9	15.9	1.5
RN-PNS-0613	M6	7.10-12.7	10	8.79	32.8	15.9	1
RN-PNS-0807	M8	0.5-7.10	12.7	11.1	30.5	19	1.57
RN-PNS-0813	M8	7.1-12.7	12.7	11.1	36.5	19	1.57
RN-PNS-1007	M10	0.5-7.10	15.1	14.95	33.1	22.3	2.2

Thread Size	Pull-Out KN	Push-Out KN	Maximum Torque NM
M5	-	-	-
M6	12.5	5.9	22.1
M8	19.7	32	42.9
M10	-	-	-

Diagrams and Drawings are for illustrative and measuring purposes only. Dimensions and specifications are subject to change without notice. Check your distributor for the latest data sheet. The test data provides approximate strength values averaged in multiple tests in various materials and thicknesses.

www.rivnut.com.au

Rivstuds



1300 887 341
 sales@rivnut.com.au
 Unit 3, 57 Boyland Avenue,
 Coopers Plains, Qld 4108

Large Flange Steel Rivstuds

Material Low Carbon Steel

Finish: Zinc Clear Cr3

Flat head with splined body, designed for use in hard metric dimensioned drilled or punched holes.

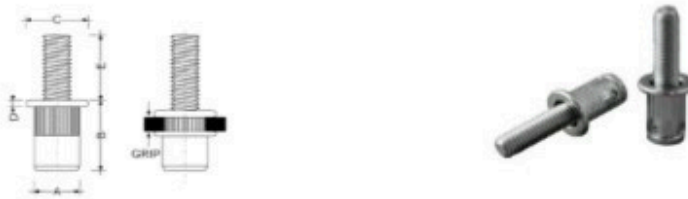

Part Number	Thread	Grip Range	A	B	C	D	E
RS0425-15	M4	0.5-2.5	5.95	12.00	9.00	1.00	15.00
RS0530-15	M5	0.5-3.0	6.95	13.00	10.00	1.00	15.00
RS0630-20	M6	0.5-3.0	8.95	15.50	13.00	1.50	20.00
RS0830-20	M8	0.5-3.0	10.95	17.50	16.00	1.50	20.00

Thread Size	Pull-Out KN	Push-Out KN	Maximum Torque NM
M4	7.80	2.90	5.90
M5	7.80	2.90	7.00
M6	12.70	3.90	9.80
M8	18.60	5.90	19.60

Diagrams and Drawings are for measuring purposes only. Dimensions and specifications are subject to change without notice. The test data provides approximate strength values averaged in multiple tests in various materials and thicknesses.

www.rivnut.com.au