



Rivnut
Fastening Systems

1300 887 341
sales@rivnut.com.au
Unit 3, 57 Boyland Avenue,
Coopers Plains, Qld 4108

Rivnut Small Flange Steel - Closed End

Material Low Carbon Steel

Finish Zinc Plated



Highest resistance to vibration and spin out of all round bodied rivnuts. Flange are wide and near flush finish. Very wide grip range.

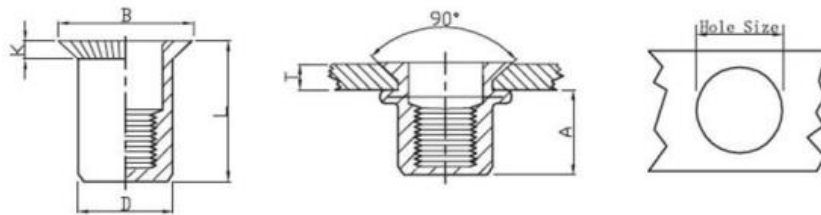

| Part Number | Thread | Grip Range | Hole Size | D | L | B | K |
|-------------|--------|------------|-----------|-------|-------|-------|------|
| RNFFSSE04CE | M4 | 0.5-2.5 | 6 | 6.00 | 15.00 | 6.80 | 0.50 |
| RNFFSSE05CE | M5 | 0.5-2.5 | 7 | 7.00 | 18.00 | 7.90 | 0.50 |
| RNFFSSE06CE | M6 | 0.5-3.0 | 9 | 9.00 | 21.50 | 10.00 | 0.50 |
| RNFFSSE08CE | M8 | 1.0-3.0 | 11 | 11.00 | 22.50 | 12.00 | 0.50 |

| Thread Size | Pull-Out | | Maximum Torque NM |
|-------------|----------|------|-------------------|
| | KN | KN | |
| M4 | 1.50 | 1.50 | 5.10 |
| M5 | 2.00 | 2.00 | 7.80 |
| M6 | 2.50 | 2.50 | 12.40 |
| M8 | 2.90 | 2.90 | 16.40 |

Dimensions and specifications are subject to change without notice.

www.rivnut.com.au