



Rivnut Large Flange Stainless Steel - Hex Body

Material Stainless Steel A2
Finish Stainless Steel A2



Highest resistance to vibration and spin out of all round bodied rivnuts. Flange are wide and near flush finish. Very wide grip range.

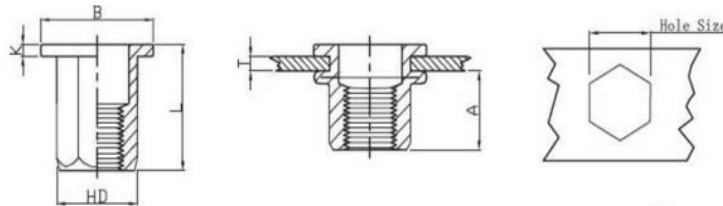

Part Number	Thread	Grip Range	Hole Size	HD	L	B	K
HEX-SLFE-0420	M4	0.5-2.0	6	6.00	10.75	9.00	0.80
HEX-SLFE-0530	M5	0.5-3.0	7	7.00	13.80	10.00	1.00
HEX-SLFE-0630	M6	0.6-3.0	9	9.00	16.00	13.00	1.50
HEX-SLFE-0830	M8	0.7-3.0	11	11.00	18.00	16.00	1.50
HEX-SLFE-1040	M10	1.0-4.5	13	13.00	24.00	19.00	2.00

Thread Size	Pull-Out KN	Push-Out KN	Maximum Torque NM
M4	6.30	2.00	4.90
M5	8.80	3.60	7.80
M6	14.40	5.30	12.00
M8	15.00	8.00	32.00
M10	19.70	9.00	45.00

Dimensions and specifications are subject to change without notice.