



Rivnut
Fastening Systems

1300 887 341
sales@rivnut.com.au
Unit 3, 57 Boyland Avenue,
Coopers Plains, Qld 4108

Rivnut Large Flange Stainless Steel-Euro

Material Stainless Steel A2
Finish Stainless Steel A2



Optimal for high push-out applications. Straight metric hole sizes. Splined body improves torque-to-turn resistance

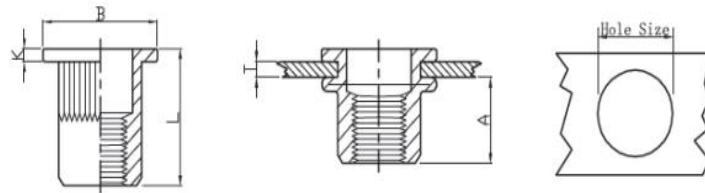

Part Number	Thread	Grip	Hole Size	A	B	L	K
RNLFST03	M3	0.5-2.0	5	6.00	8.00	10.00	0.80
RNLFST04	M4	0.5-2.5	6	6.00	9.00	10.50	0.80
RNLFST04-L	M4	2.5-4.0	6	6.00	9.00	12.00	0.80
RNLFST05	M5	0.7-3.0	7	7.50	10.00	13.00	1.00
RNLFST05-L	M5	2.5-4.0	7	8.50	10.00	16.50	1.00
RNLFST06	M6	0.5-3.0	9	9.20	12.30	15.50	1.30
RNLFST06-L	M6	2.5-5.0	9	10.50	12.30	19.50	1.30
RNLFST08	M8	1.0-3.0	11	11.50	14.50	18.50	1.50
RNLFST08-L	M8	3.0-5.5	11	11.50	14.50	21.00	1.50
RNLFST10	M10	1.0-4.0	13	13.50	17.00	21.50	1.70
RNLFST10-L	M10	4.5-6.0	13	13.50	17.00	24.00	1.70
RNLFST12	M12	1.0-4.0	16	13.50	18.00	22.00	2.00

Thread Size	Pull-Out	Push-Out	Maximum Torque NM
M3	5.30	3.30	3.00
M4	9.80	4.90	4.90
M5	15.70	6.90	9.80
M6	20.60	9.80	15.50
M8	29.40	12.70	29.50
M10	42.20	15.70	35.00

Dimensions and specifications are subject to change without notice.

www.rivnut.com.au