

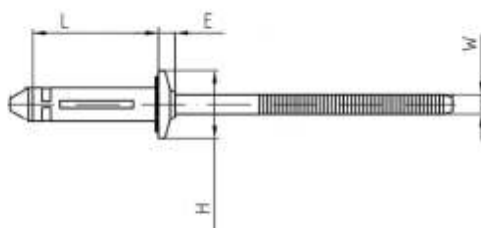

BULB TITE DOME HEAD STEEL

Material Steel
Finish Zinc



| Part Number | Diameter | Grip Range | Hole Size | L | H | E | W |
|---------------|----------|------------|-----------|-------|-------|------|------|
| RV6676-08-6W | 6.4 | 3.2-9.5 | 6.5 | 23.90 | 14.00 | 2.80 | 3.90 |
| RV6676-08-10W | 6.4 | 9.5-15.9 | 6.5 | 30.20 | 14.00 | 2.80 | 3.90 |

| Part Number | Shear Strength KN | Tensile Strength KN |
|--------------|----------------------|------------------------|
| RV6676-08-6W | 5.57 | 4.23 |

Dimensions and specifications are subject to change without notice.



BULB TITE DOME HEAD ALUMINIUM

Material ALUMINIUM
Finish ALUMINIUM

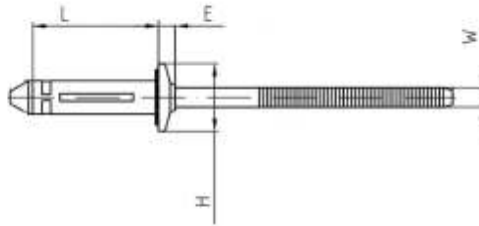

| Part Number | Diameter | Grip Range | Hole Size | L | H | E | W |
|---------------|----------|------------|-----------|-------|-------|------|------|
| RV6605-09-6W | 7.8 | 1.0-9.5 | 8 | 28.20 | 19.40 | 5.35 | 4.50 |
| RV6605-09-10W | 7.8 | 6.4-15.9 | 8 | 30.20 | 19.40 | 5.35 | 4.50 |

| Part Number | Shear Strength KN | Tensile Strength KN |
|--------------|----------------------|------------------------|
| RV6605-09-6W | 5.80 | 4.50 |

Dimensions and specifications are subject to change without notice.



BULB TITE DOME HEAD ALUMINIUM

Material ALUMINIUM
Finish ALUMINIUM

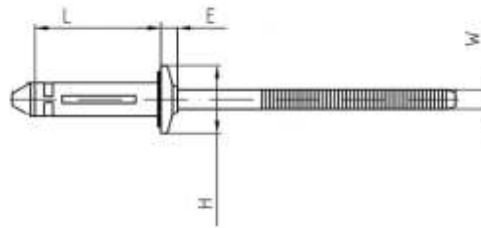

| Part Number | Diameter | Grip Range | Hole Size | L | H | E | W |
|--------------|----------|------------|-----------|-------|-------|------|------|
| RV6604-06-4W | 4.8 | 1.6-6.4 | 5.5 | 19.10 | 11.90 | 2.40 | 2.80 |
| RV6604-06-6W | 4.8 | 4.8-9.5 | 5.5 | 22.20 | 11.90 | 2.40 | 2.80 |
| RV6604-06-8W | 4.8 | 7.9-12.7 | 5.5 | 25.40 | 11.90 | 2.40 | 2.80 |

| Part Number | Shear Strength KN | Tensile Strength KN |
|-------------|----------------------|------------------------|
| RV6604-06 | 2.70 | 1.95 |

Dimensions and specifications are subject to change without notice.